

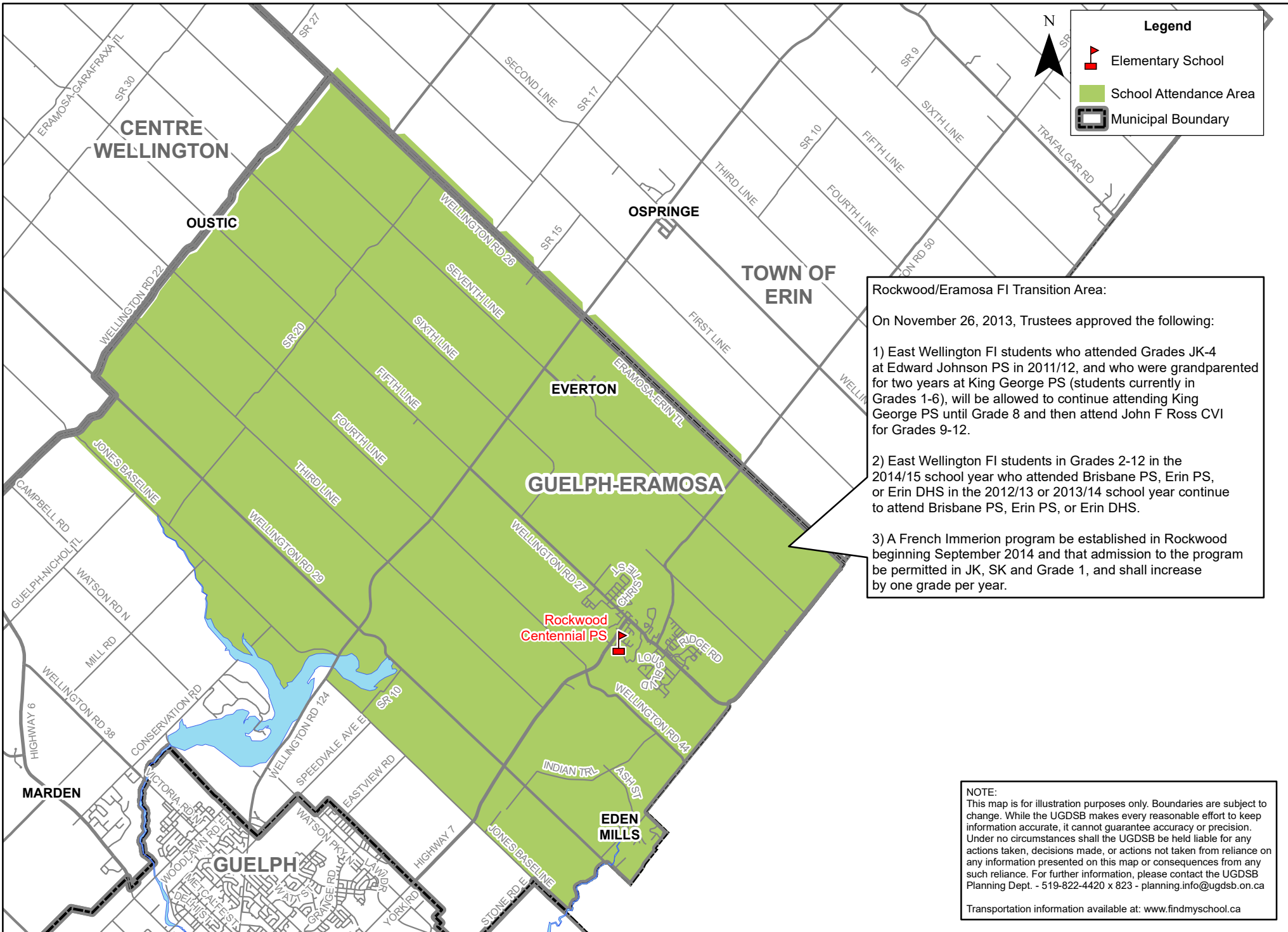



Rockwood Centennial PS French Immersion 6 to 8 Attendance Area



Legend

-  Elementary School
-  School Attendance Area
-  Municipal Boundary

Rockwood/Eramosa FI Transition Area:

On November 26, 2013, Trustees approved the following:

- 1) East Wellington FI students who attended Grades JK-4 at Edward Johnson PS in 2011/12, and who were grandparented for two years at King George PS (students currently in Grades 1-6), will be allowed to continue attending King George PS until Grade 8 and then attend John F Ross CVI for Grades 9-12.
- 2) East Wellington FI students in Grades 2-12 in the 2014/15 school year who attended Brisbane PS, Erin PS, or Erin DHS in the 2012/13 or 2013/14 school year continue to attend Brisbane PS, Erin PS, or Erin DHS.
- 3) A French Immersion program be established in Rockwood beginning September 2014 and that admission to the program be permitted in JK, SK and Grade 1, and shall increase by one grade per year.

NOTE:
 This map is for illustration purposes only. Boundaries are subject to change. While the UGDSB makes every reasonable effort to keep information accurate, it cannot guarantee accuracy or precision. Under no circumstances shall the UGDSB be held liable for any actions taken, decisions made, or actions not taken from reliance on any information presented on this map or consequences from any such reliance. For further information, please contact the UGDSB Planning Dept. - 519-822-4420 x 823 - planning.info@ugdsb.on.ca

Transportation information available at: www.findmyschool.ca